

INDUSTRIAL PROPERTY
MEMPHIS, TN.

TRUCK/CONTAINER YARD

9.22 Acres For Sale

Convenient On / Off to Expressway

I-55 & Mallory Ave. (Exit 9)

Go East Two Blocks

Situated on South Side of Mallory

Sales Price: \$603,000.00

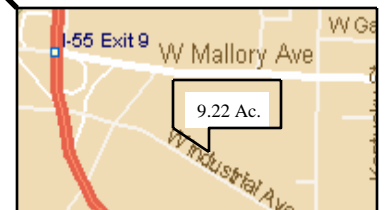
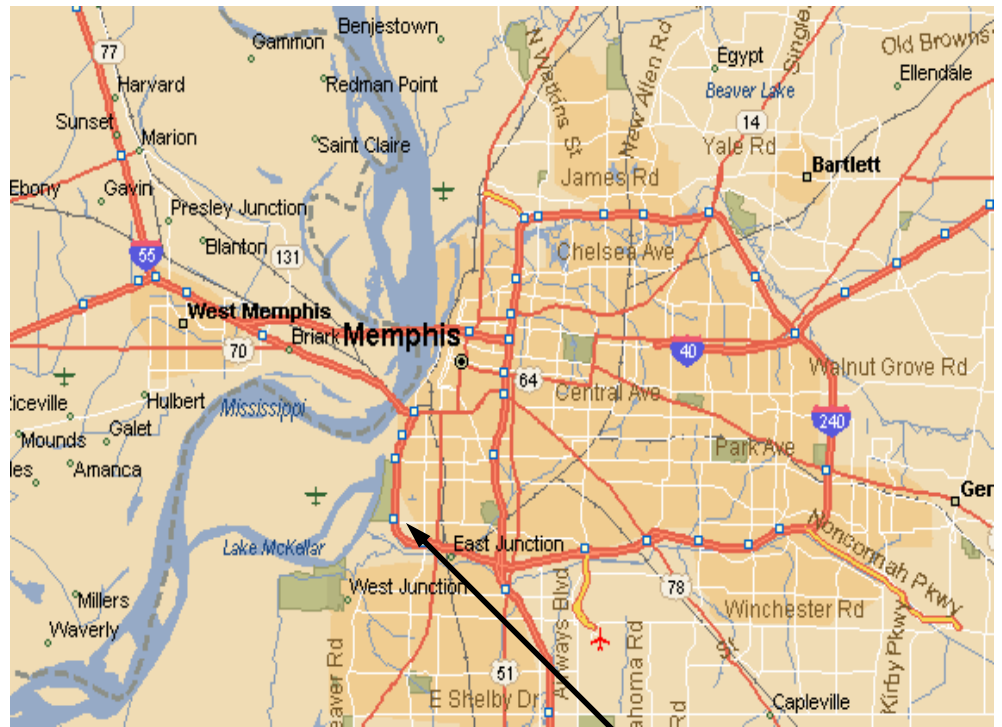

- 2 Blocks off I-55 (Exit 9)
- Completely Fenced
- Presently Leased on Month-to-Month Basis
- Zoning is I-H
- Largest Concentration of Railroad Lines in County. Other Industrial Use Areas located nearby are President's Island, Frank Pidgeon Industrial Park with Birmingham Steel, Rivergate Industrial Port, MAPCO & Proposed Memphis Joint Intermodal Terminal (MJIT)

Vernon D. Turk Jr., CCIM
Turk Realty

P. O. Box 2284
West Memphis, AR 72303

Phone: 870-732-2283
Fax: 870-735-0652
Email: VTurkjr@aol.com

This information is believed to be accurate. We are not responsible for misstatements of facts, errors, or omissions, change of price or withdrawal from the market.



235 West Mallory Avenue, Memphis, TN

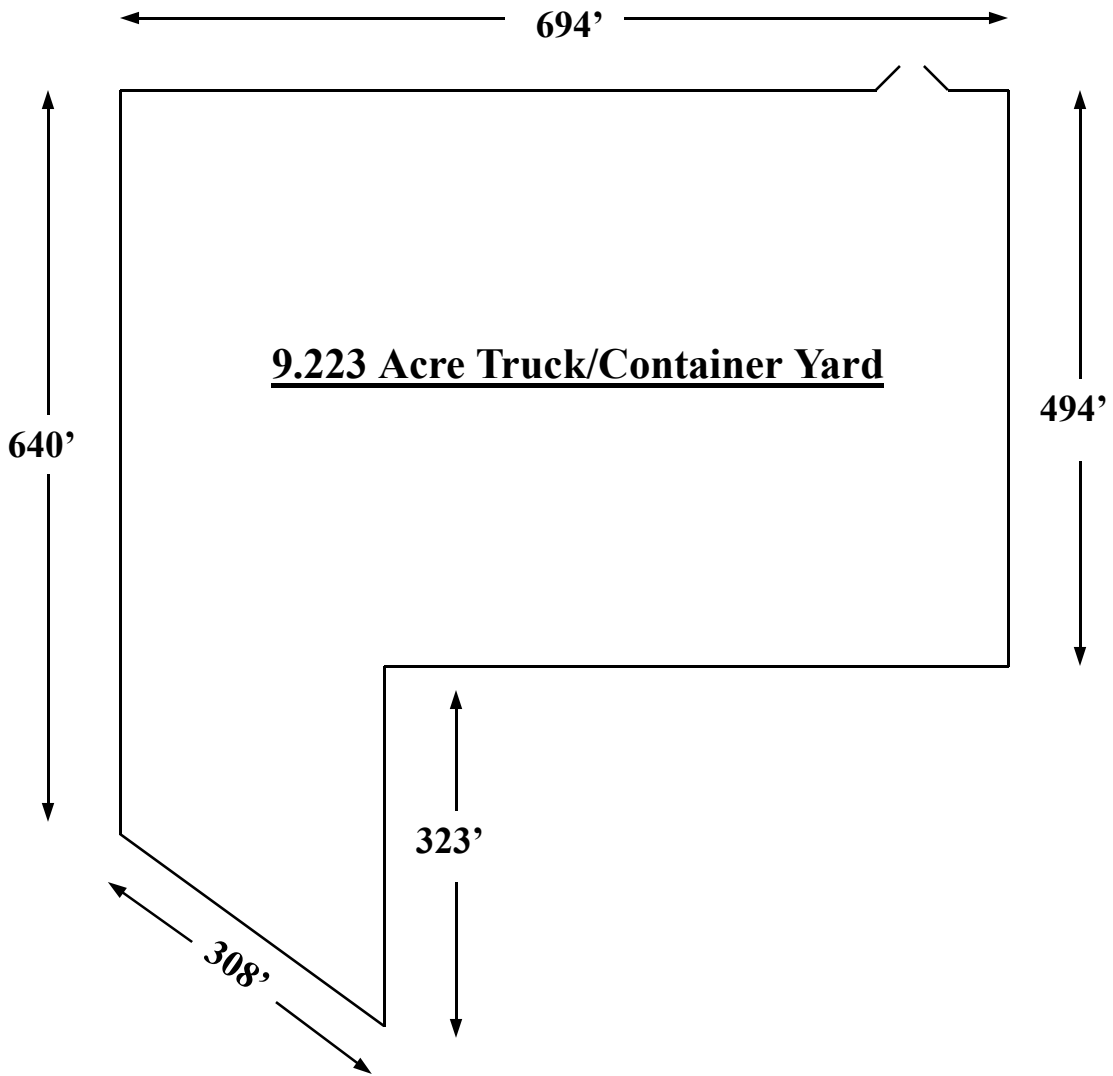

This information is for reference purposes only. The dimensions need to be verified by a survey. We are not responsible for misstatements of facts, errors, or omissions, change of price or withdrawal from the market.